

# Miniature Circular Connectors

Derived from JN 1003 & MIL-DTL-38999

## 8STA & 8TA

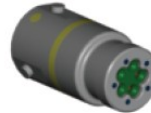
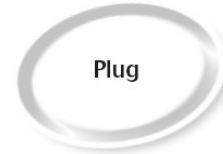
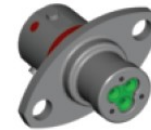

*The Autosport Connector of Choice*

*from*

*The Connector Supplier of Choice*

## 8STA Shell Sizes 02-24

### Ordering Information

*Required*

*Optional*

Basic Series	8STA	6	14	35	P	N	S1	NG
<b>Shell Style</b>	0: Oval Flange Box Receptacle 1: In Line Receptacle 2: Oval Flange Receptacle with PCB Contacts 6: Plug Connector 7: Jam Nut Receptacle							
<b>Shell Size</b>	02, 04, 06, 08, 10, 12, 14, 16, 18, 20, 22, 24							
<b>Contact Layouts</b>	Refer to Catalogue							
<b>Type of Contacts</b>	P: Pin Contacts S: Socket Contacts							
<b>Orientation</b>	N (Red) A (Yellow) B (Blue) C (Orange) D (Green) U (Universal)							
<b>Heatshrink Boot Style</b>	S1: Straight, Size1 (small) S2: Straight, Size 2 (large) R1: 90 Degree, Size 1 (small) R2: 90 Degree, Size 2 (large) C***: Custom (as quoted / agreed, various options available)							
<b>Accessory</b>	N: Nut Plate P: Metal Protective Cap (8STA8 or 9 as appropriate) G: Gasket							

# 8STA Shell Sizes 02-24

## Straight Heat Shrink Boot Options

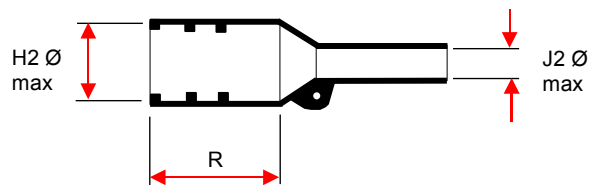
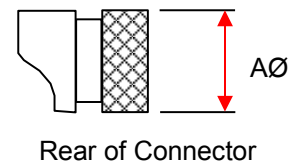
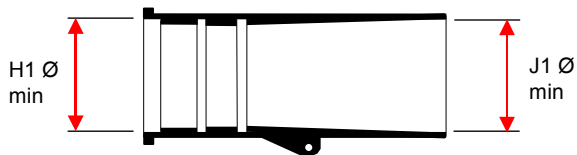

**S1 (recommended)**

**S2**

Shell Size	AØ	S1 (recommended)							S2				
		S1 (Tyco Part No)	H1	H2	J1	J2	R	S2 (Tyco Part No)	H1	H2	J1	J2	R
02	7.2	203w301-x-G12	11	5.3	6	2	11	202k111	17	6.9	17	3	24
04	8.5	203w301-x-G12	11	5.3	6	2	11	202k111	17	6.9	17	3	
06	9.75	203w301-X-G12	11	5.3	6	2	11	202k111	17	6.9	17	3	24
08	10.62	202k111	17	6.9	17	3	24	202K121	24	10.4	24	5.6	21
10	13.72	202k111	17	6.9	17	3	24	202K132	30	14.2	30	5.9	32
12	17.26	202k132	30	14.2	30	5.9	32	202k142	31	18	31	7.1	35
14	20.41	202k132	30	14.2	30	5.9	32	202k142	31	18	31	7.1	35
16	23.6	202k142	31	18	31	7.1	35	202k153	36	22.4	36	8.4	
18	26.76	202k142	31	18	31	7.1	35	202k153	36	22.4	36	8.4	
20	29.93	202k153	36	22.4	36	8.4	42	202k163	43	28.2	43	9.9	
22	33.11	202k153	36	22.4	36	8.4	42	202k163	43	28.2	43	9.9	61
24	36.3	202k163	43	28.2	43	9.9	61	202k174	60	35.1	60	15.7	72

# 8STA Shell Sizes 02-24

## 90° Heat Shrink Boot Options

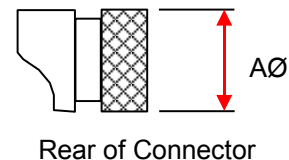
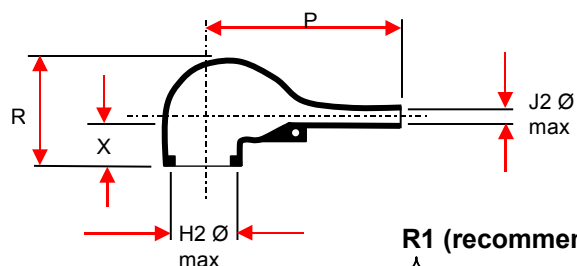
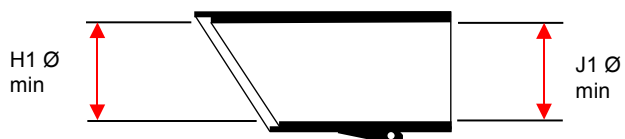

**R1 (recommended)**

**R2**

Shell Size	AØ	R1 (Tyco Part No)	H1	H2	J1	J2	R	P	X	R2 (Tyco Part No)	H1	H2	J1	J2	R	P	X
02	7.2	224w201	11	5.2	9	1.4	11.5	13	/	224w221-x-G03	11	7.8	11	1.9	13	12.3	/
04	8.5	224w201	11	5.2	9	1.4	11.5	13	/	224w221-x-G03	11	7.8	11	1.9	13	12.3	/
06	9.75	224w201	11	5.2	9	1.4	11.5	13	/	224w221-x-G03	11	7.8	11	1.9	13	12.3	/
08	10.62	224W221-x-G03	17	9.3	17	2.1	13	12.3	/	222K121	24	10.4	24	5.6	25	25	18
10	13.72	222k121	10.4	24	24	5.6	25	25	18	222K132	30	14.2	30	5.9	27	32	18
12	17.26	222k132	30	14.2	30	5.9	27	32	18	222k142	31	18	31	7.1	31	39	18
14	20.41	222k132	30	14.2	30	5.9	27	32	18	222k142	31	18	31	7.1	31	39	18
16	23.6	222k142	31	18	31	7.1	31	39	18	222k152	36	22.4	36	8.4	38	46	25
18	26.76	222k142	31	18	31	7.1	31	39	18	222k152	36	22.4	36	8.4	38	46	25
20	29.93	222k152	36	22.4	36	8.4	38	46	25	222k163	43	28.2	43	9.9	45	55	63
22	29.93	222k152	36	22.4	36	8.4	38	46	25	222k163	43	28.2	43	9.9	45	55	25
24	36.3	222k163	43	28.2	43	9.9	45	55	25								



# 8STA Shell Sizes 02-24

## Nut Plate and Gasket Options

### Nut Plates

Shell Size	Connector Number Suffix	Thread	Catalogue Part No:
02	N	M2.0	8STA-02
02	N2	M2.5	8STA-02M2.5
04	N	M2.0	8STA-04
04	N2	M2.5	8STA-04M2.5
06	N	M3.5	8STA-06
08	N	M3.5	8STA-08
10	N	M3.5	8STA-10
12	N	M3.5	8STA-12
14	N	M3.5	8STA-14
16	N	M3.5	8STA-16
18	N	M3.5	8STA-18
20	N	M3.5	8STA-20
22	N	M3.5	8STA-22
24	N	M3.5	8STA-24

### Std Gaskets

Shell Size	Connector Number Suffix	Catalogue Part No:
02	G	8STAG02
04	G	8STAG04
06	G	8STAG06
08	G	8STAG08
10	G	8STAG10
12	G	8STAG12
14	G	8STAG14
16	G	8STAG16
18	G	8STAG18
20	G	8STAG20
22	G	8STAG22
24	G	8STAG24

### Fuel Resistant Gaskets

Shell Size	Connector Number Suffix	Catalogue Part No:
02	GF	8STAG02022
04	GF	8STAG04022
06	GF	8STAG06022
08	GF	8STAG08022
10	GF	8STAG10022
12	GF	8STAG12022
14	GF	8STAG14022
16	GF	8STAG16022
18	GF	8STAG18022
20	GF	8STAG20022
22	GF	8STAG22022
24	GF	8STAG24022

# 8STA Shell Sizes 02-24

## Crimp and Tool Options, Contact sizes 20 to 26

Contact Size	Contact Type / Gender	Connector Planforms Used In	Crimp Tool Locator Options		Insertion / Extraction tool Options		Type
20	Pin	standard	M22520/2-10	8476-10	M81969/14-10		Plastic
	Socket	standard	M22520/2-10	8476-10	M81969/14-10		Plastic
22D	Pin	02-35, 04-35, 06-35	M22520/2-09	8476-09	M81969/14-01		Plastic
	Socket	02-35, 04-35, 06-35	M22520/2-06	8476-06	M81969/14-01		Plastic
22D	Pin	-35 Planforms, shells 8-24	M22520/2-09	8476-09	M81969/14-01		Plastic
	Socket	-35 Planforms, shells 8-24	M22520/2-07	8476-07	M81969/14-01		Plastic
26	Pin	04-05	640083		M81969/14-01		Plastic
	Socket	04-05	640084		M81969/14-01		Plastic
26	Pin	02-05, 04-06	640088		RF46114	8599-1006	Metal
	Socket	02-05, 04-06	640089		RF46114	8599-1006	Metal

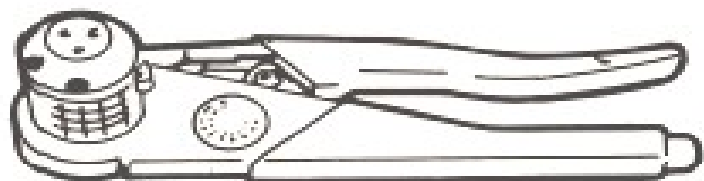
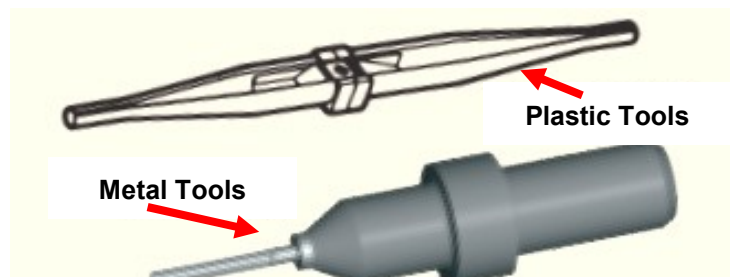

Positioner's / Locators

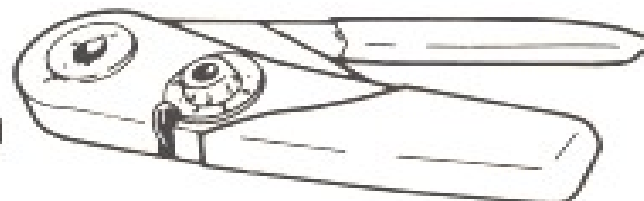
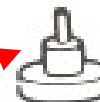

# Contact layouts

Shell size 02		Shell size 04						
05  5#26 Service R	35  3#22D Service S	05  5#26 Service R	06  6#26 Service R	35  3#22D Service S				
Shell size 06		Shell size 08						
05  5#26 Service M	35  5#22D Service M	35  6#22D Service M	98  3#20 Service I					
Shell size 10								
01  1#12 Service II	02  2#16 Service I	04  4#20 Service I	05  5#20 Service I	35  13#22D Service M	80  1#8 triax Service I	98  6#20 Service I	99  7#20 Service I	
Shell size 12								
01 Spec 261 only  1#4 Service M	04  4#16 Service I	08  8#20 Service I	26  6#22D 2#12 Service M	35  22#22D Service M	98  10#20 Service I			
Shell size 14								
05  5#16 Service II	18  18#20 Service I	19  19#20 Service I	35  37#22 Service M	97  6#20 4#16 Service I				
Shell size 16								
02  1#8 power 38#22 Service II	06  6#12 Service I	08  8#16 Service II	26  26#20 Service I	35  55#22D Service M	75  8#8 triax Service M	99  2#16 21#20 Service I		

## Contact layouts

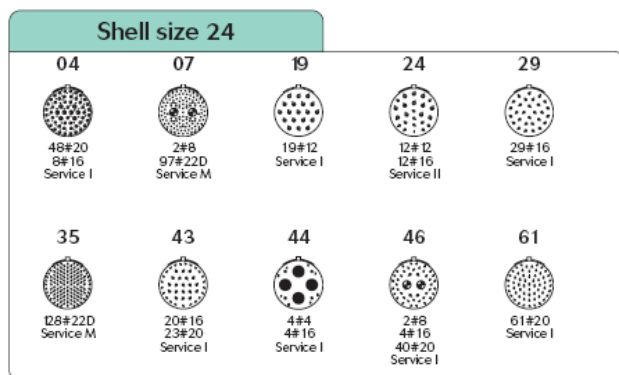
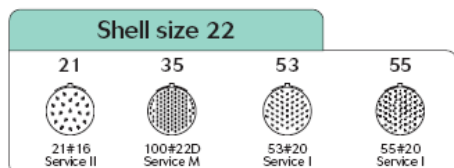
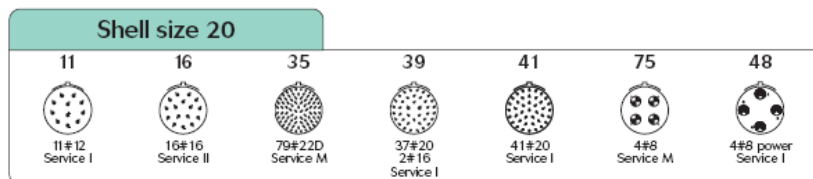
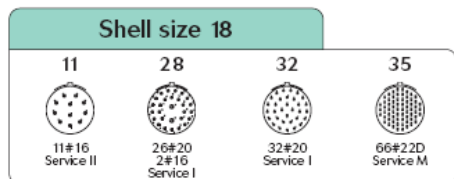

Service	Sea level	At 21000m
R	400	N/A
S	1000	N/A
M	1300	800
N	1000	600
I	1800	1000
II	2300	1000

